

**Part - A**  
**Detailed and Abstract Estimate**

**Name of Work:** Model Estimate for Construction of Godown

**Financial Year:** 2015-16

**Head of Account:** MGNREGS

- 1a. Some of the rates adopted in this estimate are as per PW, P & IWTD, schedule of rates of Bengaluru circle for 2014-15 continued for 2015-16.
- 1b. The area weightage pertaining to the respective areas to be adopted as per respective schedule of rates of respective circles of respective departments.
2. Some of the rates adopted in this estimate are also Nrega SoR for year 2015-16.
3. This is only a model estimate, the Officer/Engineer-in-charge should visit the site and prepare the estimate based on (i) Actual site conditions. (ii) Foundation to be designed as per existing geological conditions.
4. The overall variations in the cost should not exceed 10% of the estimated cost. In case if it exceeds 10% same should be got approved from the Commissionerate.
5. KPPP 1999 should be followed while tendering and procurement of materials
6. The Contractor profit of 10% should be deducted in case of departmental works.

Sl.No.	Item as per SoR (Prevailing NREGA or Line Dept., or as approved Data Sheet)	Unit	Measurements					Rate (in Rs.)	Amount (in Rs.) (Col 8 x 9)
			No.	Length	Breadth (in Mtr.)	Depth (in Mtr.)	Quantity		
1	2	3	4	5	6	7	8	9	10
1	KSRB 2-2.1 : Earthwork excavation for foundation of buildings, culverts, watersupply, sanitary lines and electrical conduits either in pits or in trenches 1.5m and above in width, in ordinary soil not exceeding 1.5 m. in depth including dressing the bottom and sides of pits and trenches, stacking the excavated soil clear from edges of excavation with lead upto 50 m. after breaking of clods complete as per specifications. specification. No.KBS 2.1(a) / 2.3.5 (PWD SR 2014-15, Item No 2.3 Page 5)								
	Columns		10	1.20	1.20	1.20	17.28		
	Walls LW		2	12.86	0.90	1.20	27.78		
	Walls SW		2	8.01	0.90	1.20	17.30		
							62.36		
	Deduction		10	1.20	0.90	1.20	12.96		
	Total Qty	Cum					49.40	198.06	9,784.01
	Basic Rate	198.06							
	Area weightage 6%								
	<b>Total Rate</b>	<b>198.06</b>							
2	KSRB 4-1.2 : Providing and laying in position plain cement concrete of mix M10 with OPC cement @ 220kgs, with 40mm and down size graded granite metal coarse aggregates @0.892cum and fine aggregates @ 0.465cum machine mixed, machine mixed, concrete laid in layers not exceeding 15 cms. thick, well compacted, in foundation and plinth, cost of all materials, labour, HOM of machinery, curing complete as per specifications. Specification No. KBS 4.1, 4.2 (PWD SR 2014-15, Item No 4.2, Page 12)								
	Columns		10	1.20	1.20	0.15	2.16		
	Walls LW		2	12.86	0.90	0.15	3.47		
	Walls SW		2	8.01	0.90	0.15	2.16		
							7.79		
	Deduction		10	1.20	1.20	0.15	2.16		
	Total Qty	Cum					5.63	4,689.00	26,422.05
	Basic Rate	4,689.00							
	Area weightage 6%								
	<b>Total Rate</b>	<b>4,689.00</b>							
3	KSRB 4.2.2 : Providing and laying in position reinforced cement concrete of design mix M20 with OPC cement @ 320kgs, with 20mm and down size graded granite metal coarse aggregates @0.69cum and fine aggregates @ 0.46cum, with superplasticiser @3lts conforming to IS9103-1999 Reaffirmed-2008, machine mixed, concrete laid in layers not exceeding 15 cms thick, vibrated for all works in foundation plinth and ground floor level for roof slabs, staircase, lintels, retaining walls, return walls, walls ( any thickness ) including attached plasters, columns, piers, abutments, pillars, posts, struts, buttresses, string or lacing courses, parapets, coping, bed blocks, anchor blocks, plain window cills, fillets etc., including cost of all materials, labour, HOM of machinery, curing, complete as per specifications. Specification No. KBS 4.1, 4.6 (PWD SR 2014-15 Item No. 4.1, Page 13)								
	Column Footing		10	1.20	1.20	0.45	6.48		
	Total Rate		10	0.23	0.45	6.45	6.68		
	Plinth Beam		1	41.74	0.23	0.45	4.32		
	Flooring		1	11.73	8.68	0.10	10.18		
	Through Lintels		2	41.74	0.23	0.30	5.76		
	Beams		4	9.14	0.23	0.62	5.21		
			2	12.13	0.23	0.30	1.67		
	Slab		1	13.09	10.30	0.13	16.85		
	Total Qty	Cum					57.16	5,743.00	3,28,260.52
	Basic Rate	5,743.00							
	Area weightage 6%								
	<b>Total Rate</b>	<b>5,743.00</b>							
4	KSRB 5.2-2: Providing and constructing granite / trap / basalt size stone masonry in foundation with cement mortar 1:8, stone hammerd dressed in caourses not less than 20cms high, bond sotnes at two m. apart in each course including cost of materials, labour, curing complete as per specification. KSRB 5.2-3 : -do- Cement mortar 1:6 (PWD SR 2014-15, Item No. 5.6 Page 23)								
	Walls LW		2	12.71	0.75	0.60	11.44		
	Walls SW		2	8.16	0.75	0.60	7.34		

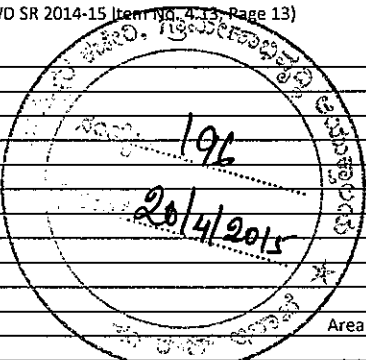

	Walls LW		2	12.56	0.60	0.45	6.78		
	Walls SW		2	8.31	0.60	0.45	4.49		
							30.05		
	Deduction		10	1.20	1.20	0.60	8.64		
			10	0.23	0.45	0.45	0.47		
	Total Qty	Cum					20.95	3,552.00	74,403.92
	Basic Rate	3,552.00							
	Area weightage 6%								
	Total Rate	3,552.00							
5	KSRB -2.3: Filling available excavated earth (excluding rock) in sides of foundation upto plinth in layers not exceeding 20cms in depth compacting each deposited layer by ramming after watering with lead upto 50m and lift upto 1.5m including cost of all labour complete as per specifications. (PWD SR 2014-15, Item No 2.10, Page 6)								
			1	11.73	8.68	0.45	45.82	110.00	5,039.91
	Total Qty	Cum							
	Basic Rate	110.00							
	Area weightage 6%								
	Total Rate	110.00							
6	KSRB 5-14: Providing and constructing precast concrete solid blocks with compressive strength not less than 35Kg/Sqm with cement mortar 1:4 masonry (Quoin, Jamb, Closer blocks) with solid concrete blocks of size 40x20x20cms conforming to I.S:2185/1965 in superstructure including cost of materials, labour charges, scaffolding, curing complete as per specification. (PWD SR 2014-15, Item No 5.27.1, Page 25)								
	Walls LW		2	12.19		5.55	135.31		
	Walls SW		2	8.68		5.55	96.35		
							231.66		
	Deduction								
	Deduction col		10	0.23		0.60	1.38		
	Ventilators		10	0.23		0.60	1.38		
	RS		2	3.05		3.65	22.27		
							25.03		
	Total Qty	Cum					206.63	920.00	1,90,101.44
	Basic Rate	920.00							
	Area weightage 6%								
	Total Rate	920.00							
7	KSRB 4.9.2 : Providing T.M.T. steel reinforcement for R.C.C work including straightening, cutting, bending, hooking, placing in position, lapping and / or welding wherever required, tying with binding wire and anchoring to the adjoining members wherever necessary complete as per design (laps, hooks and wastage shall not be measured and paid) cost of materials, labour, HOM of machinery complete as per specifications. Specification No. KBS 4.6.3 (PWD SR 2014-15 Item No 4.46.2, Page 17)								
	Qty as per Ino.3								
	Footing		1	6.48	80.00		518.40		
	Plinth Beam		1	4.32	120.00		518.40		
	Column		1	6.68	120.00		801.60		
	Lintel		1	5.76	60.00		345.60		
	Beam		1	5.21	110.00		573.10		
	Main slab		1	16.85	100.00		1,685.00		
							4,442.10		
	Total Qty	MT					4.44	72,548.00	3,22,265.47
	Basic Rate	7,254.80							
	Area weightage 6%								
	Total Rate	7,254.80							
8	KSRB 4-6.5 : Providing and removing centering, shuttering, strutting, propping etc., for columns, pillars, piers, abutments, post and struts, square / rectangular / polygon in plan including cost of all materials, labour complete as per specification. Specification No. KBS 4.6.2 (PWD SR 2014-15, Item No 4.32, Page 15)								
	Columns		10	1.36	6.00		81.60		
	PB		1	41.74	1.36		56.77		
	Col ftg		10	3.72	0.60		22.32		
	Total Qty	Sqm					160.69	338.00	54,312.00
	Basic Rate	338.00							
	Area weightage 6%								
	Total Rate	338.00							
9	KSRB 4.6.2: Providing and removing centering, shuttering, strutting, propping etc., and removal of from work for flat surface such as suspended floors, roofs, landings, balconies and likes thickness upto 200mm including cost of all materials, labour complete as per specifications, Specification No. KBS 4.6.2 (PWD SR 2014-15, Item No 4.29.2 Page 15)								
	Slab		1	13.09	10.30		134.83		
	Total Qty	Sqm					134.83	530.00	71,458.31
	Basic Rate	530.00							
	Area weightage 6%								
	Total Rate	530.00							

10	KSRB 7.10 : Providing and fixing in position aluminium windows and ventilators as per approved drawings with sliding shutters using double track window frame section of size 61.85x31.75mm. with 1.2mm thick, bottom section weight 0.695 kg/m, sides and top sections 1.3 mm. thick weight 0.659 kg/m; and shutter comprising top and bottom section of size 40mmx18mm, 1.25mm thick 0.417 kg/m; shutter outer side 40mmx18mm, 1.25mm.thick weight 0.417 kg/m, shutter interlock section 40mmx26.7mm, 1.1mm thick, weight 0.469 kg/m. the shutters mounted on nylon rollers with approved quality of fixtures such as aluminium handles tower bolts etc.; and providing and fixing 5.5mm. thick plain glass for shutters fitted with rubber beading aluminium sections including cutting to required length, joints mitred subdividing the frame tenoned and rivetted in the assembled frame stiffened with end clips at corners angles etc., and fixed to the walls, lintels, floor beams/cills as the case may be with necessary steel screws, raul plugs, or teak wood gatties including cutting masonry or concrete and making good the original surface using cement mortar, aluminium sections pretreated for removal of any Specification No. KBS (PWD SR 2014-15, Item No 7.10.1 Page 33)								
	Ventilators		10	0.60	0.60		3.60		
	Total Qty	Sqm					3.60	3,660.00	13,176.00
	Basic Rate	3,660.00							
	Area weightage 6%								
	Total Rate	3,660.00							
11	KSRB 7.5 : Providing and fixing pull and push type rolling shutters of approved make out of 18 guage, 75mm wide cold rolled steel laths of convex corrugation, with side guides and bottom rail, with interlocking arrangements for steel laths by means of alternate clips, suspension shaft with High tension coil type springs two numbers, mounted on specially designed pipe shaft, with bracket plates, guide channels, ball bearing arrangements, for inside & outside locking with push & pull operations complete including pulling hooks, 4Nos. handles with all fittings and accessories, painted with a coat of red lead paint (without top cover) cost of materials, labour, HOM of machinery complete as per specifications. Shutter size 3mx2.8 m Specification No. KBS 7.10 / 7.12 (PWD SR 2014-15, Item No 7.5, Page 31)								
	Total Qty	Sqm	2	3.05	3.65		22.27		
	Basic Rate	2,661.00					22.27	2,661.00	59,247.17
	Area weightage 6%								
	Total Rate	2,661.00							
12	Providing and fixing top covers made out of 20 guage M.S. sheet over pull and push rolling shutters bent to shape including cost of red lead primer coat of painting , materials, labour, HOM of machinery complete as per specifications. (PWD SR 2014-15, Item No 7.6, Page 32)								
	Total Qty	Mtr	2	3.05			6.10		
	Basic Rate	609.00					6.10	609.00	3,714.90
	Area weightage 6%								
	Total Rate	609.00							
13	KSRB 15.3.1 Providing 12mm thick cement plaster in single coat with cement mortar 1:3, to brick masonry including rounding off corners wherever required smooth rendering. : Providing and removing scaffolding, including cost of materials, labour, curing complete as per specifications. (PWD SR 2014-15, Item No 15.9 Page 109)								
	I/S LW		2	11.73	5.55		130.20		
	Walls SW		2	8.68	5.55		96.35		
	O/S LW		2	12.19	5.55		135.31		
	Walls SW		2	9.14	5.55		101.45		
							463.31		
	Deduction col		10	0.60	0.60		3.60		
	RS		2	3.05	3.65		22.27		
							25.87		
	Total Qty	Sqm					437.45	162.00	70,866.74
	Basic Rate	162.00							
	Area weightage 6%								
	Total Rate	162.00							
14	KSRB 15-14.1 : Providing and applying two coats with oil bound washable distemper of approved brand and shade on wall surface including priming coat with distemper primer after thoroughly brooming the surface free from mortar drops and other foreign matter including preparing the surface even and sand paper smooth, cost of materials, labour, complete as per specifications. (PWD SR 2014-15, Item No 15.49.1 Page No. 113)								
	I/s LW		2	11.73	5.55		130.20		
	Walls SW		2	8.68	5.55		96.35		
	Total Qty	Sqm					226.55	62.00	14,046.16
	Basic Rate	62.00							
	Area weightage 6%								
	Total Rate	62.00							

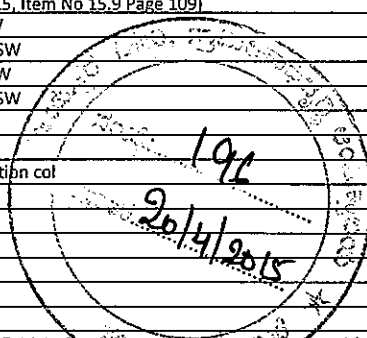

15	KSRB 15-16.1 : Providing and finishing external walls in two coats with waterproof cement paint of approved brand and shade to give an even shade after thoroughly brooming the surface to remove all dirt and loose powdered material, free from mortar drops and other foreign matter cost of materials, labour, complete as per specifications. (PWD SR 2014-15, Item No 15.53.1 Page 114)							
	O/S LW		2	12.19	5.55		135.31	
	Walls SW		2	9.14	5.55		101.45	
		Total Qty	Sqm				236.76	54.00
		Basic Rate	54.00					12,785.20
		Area weightage 6%						
		Total Rate	54.00					
16	Electrification							
		Total Qty	LS					50,000.00
		Basic Rate						50,000.00
		Area weightage 6%						
		Total Rate	0.00					
							Total	13,05,883.80
17	Add 1% for Technical Supervision							13,058.84
18	Add for sharpening charges 565x@Rs. 10/day/person							5,650.00
19	Name board and rounding off							1,407.36
							Grand Total	13,26,000.00

Sign of Engineer

Sign of PDO / Secretary and Seal

Sign of President of GP and Seal

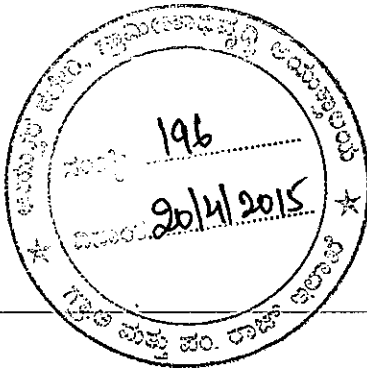

Part - B  
 Detailed Estimation (Calculation) of Labour and Material requirement

Sl.No.	Item as per SoR (Prevailing NREGA or Line Dept., or as approved Data Sheet) as in Part - A detailed and abstract estimate	Unit	Qty	Coeff for unskilled labour	Unskilled Labour Component			Total Amt.	Skilled, Semi skilled wage and Material component including essential machinery like rollers etc but excluding unskilled labour displacing machinery Amount (in Rs.)(Col 9 - 8)
					No. of Person Days	Wage rate for 2015-16 fixed by Govt. (MORD)	Amount (in Rs.) (Col 6 x 7)		
1	2	3	4	5	6	7	8	9	10
1	KSRB 2-2.1 : Earthwork excavation for foundation of buildings, culverts, watersupply, sanitary lines and electrical conduits either in pits or in trenches 1.5m and above in width, in ordinary soil not exceeding 1.5 m. in depth including dressing the bottom and sides of pits and trenches, stacking the excavated soil clear from edges of excavation with lead upto 50 m. after breaking of clods complete as per specifications. specification. No.KBS 2.1(a) / 2.3.5 (PWD SR 2014-15, Item No 2.3 Page 5)	Cum	49.40	0.97	47.92	204.00	9,775.11	9,784.01	8.89
2	KSRB 4-1.2 : Providing and laying in position plain cement concrete of mix M10 with OPC cement @ 220kgs. with 40mm and down size graded granite metal coarse aggregates @0.892cum and fine aggregates @ 0.455cum machine mixed, machine mixed, concrete laid in layers not exceeding 15 cms. thick, well compacted, in foundation and plinth, cost of all materials, labour, H.O.M of machinery, curing complete as per specifications. Specification No. KBS 4.1, 4.2 (PWD SR 2014-15, Item No 4.2, Page 12)	Cum	5.63	3.18	17.92	204.00	3,655.47	26,422.05	22,766.57
3	KSRB 4.2.2 : Providing and laying in position reinforced cement concrete of design mix M20 with OPC cement @ 320kgs. with 20mm and down size graded granite metal coarse aggregates @0.878cum and fine aggregates @ 0.459cum, with superplastisiser @3lts confirming to IS9103-1999 Reaffirmed-2008, machine mixed, concrete laid in layers not exceeding 15 cms thick, vibrated for all works in foundation plinth and ground floor level for roof slabs, staircase, lintels, retaining walls, return walls, walls ( any thickness ) including attached plasters, columns, piers, abutments, pillars, posts, struts, buttresses, string or lacing courses, parapets, coping, bed blocks, anchor blocks, plain window cills, fillers etc., including cost of all materials, labour, H.O.M of machinery, curing, complete as per specifications. Specification No. KBS 4.1, 4.6 (PWD SR 2014-15 Item No.4.11, Page 13)	Cum	57.16	3.18	181.76	204.00	37,079.78	3,28,260.52	2,91,180.75
4	KSRB 5.2.2: Providing and constructing granite / trap / basalt size stone masonry in foundation with cement mortar 1:8, stone hammerd dressed in courses not less than 20cms high, bond courses at two m. apart in each course including cost of materials, labour, curing complete as per specification-KSRB 5.2-3 : -do- Cement mortar 1:6 (PWD SR 2014-15, Item No.5.6 Page 23)	Cum	20.95	2.40	50.27	204.00	10,255.68	74,403.92	64,148.25

196

5	KSRB -2.3: Filling available excavated earth (excluding rock) in sides of foundation upto plinth in layers not exceeding 20cms in depth compacting each deposited layer by ramming after watering with lead upto 50m and lift upto 1.5m including cost of all labour complete as per specifications. (PWD SR 2014-15, Item No 2.10, Page 6)	Cum	45.82	0.30	13.75	204.00	2,804.02	5,039.91	2,235.89
6	KSRB 5-14: Providing and constructing precast concrete solid blocks with compressive strength not less than 35kg/sqm with cement mortar 1:4 masonry (Quoin, Jamb, Closer blocks) with solid concrete blocks of size 40x20x20cms conforming to I.S:2185/1965 in superstructure including cost of materials, labour charges, scaffolding, curing complete as per specification. (PWD SR 2014-15, Item No 5.27, Page 25)	Cum	206.63	0.38	77.69	204.00	15,849.50	1,90,101.44	1,74,251.94
7	KSRB 4.9.2: Providing T.M.I. steel reinforcement for R.C.C work including straightening, cutting, bending, hooking, placing in position, lapping and / or welding wherever required, tying with binding wire and anchoring to the adjoining members wherever necessary complete as per design (laps, hooks and wastage shall not be measured and paid) cost of materials, labour, HO.M of machinery complete as per specifications. Specification No. KBS 4.6.3 (PWD SR 2014-15, Item No. 4.46.2, Page 17)	MT	4.44	0.10	0.44	204.00	90.62	3,22,265.47	3,22,174.85
8	KSRB 4.6.5: Providing and removing centering, shuttering, strutting, propping etc., for columns, pillars, piers, abutments, post and struts, square / rectangular / polygon in plan including cost of all materials, labour complete as per specification. Specification No. KBS 4.6.2 (PWD SR 2014-15, Item No 4.32, Page 15)	Sqm	160.69	0.30	47.72	204.00	9,735.67	54,312.00	44,576.34
9	KSRB 4.6.2: Providing and removing centering, shuttering, strutting, propping etc., and removal of form work for flat surface such as suspended floors, roofs, landings, balconies and likes thickness upto 200mm including cost of all materials, labour complete as per specifications. Specification No. KBS 4.6.2 (PWD SR 2014-15, Item No 4.29, Page 15)	Sqm	134.83	0.00	0.00	204.00	0.00	71,458.31	71,458.31
10	KSRB 7.10: Providing and fixing in position aluminium windows and ventilators as per approved drawings with sliding shutters using double track window frame section of size 61.85x31.75mm. with 1.2mm thick, bottom section weight 0.695 kg/m, sides and top sections 1.3 mm. thick weight 0.659 kg/m; and shutter comprising top and bottom section of size 40mmx18mm, 1.25mm thick 0.417 kg/m; shutter outer side 40mmx18mm, 1.25mm thick weight 0.417 kg/m, shutter innerlock section 40mmx26.7mm, 1.1mm thick, weight 0.469 kg/m. the shutters mounted on nylon rollers with approved quality of fixtures such as aluminium handles tower bolts etc; and providing and fixing 5.5mm. thick plain glass for shutters fitted with rubber beading aluminium sections including cutting to required length, joints mitred subdividing the frame tenoned and rivetted in the assembled frame stiffened with end clips at corners angles etc, and fixed to the walls, lintels, floor beams/cills as the case may be with necessary steel screws, raul plugs, or teak wood gatties including cutting masonry or concrete and making good the original surface using cement mortar, aluminium sections pretreated for removal of any Specification No. KBS (PWD SR 2014-15, Item No 7.10 Page 33)	Sqm	3.60	2.50	9.00	204.00	1,836.00	13,176.00	11,340.00

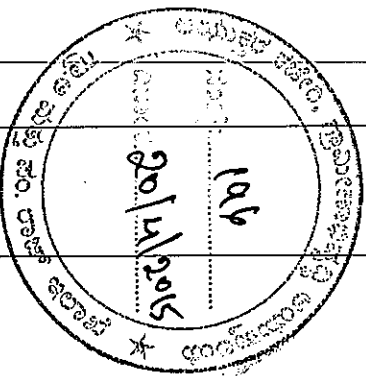

11	KSRB 7.5 : Providing and fixing pull and push type rolling shutters of approved make out of 18 gauge, 75mm wide cold rolled steel laths of convex corrugation, with side guides and bottom rail, with interlocking arrangements for steel laths by means of alternate clips, suspension shaft with High tension coil type springs two numbers, mounted on specially designed pipe shaft, with bracket plates, guide channels, ball bearing arrangements, for inside & outside locking with push & pull operations complete including pulfing hooks, 4Nos. handles with all fittings and accessories, painted with a coat of red lead paint (without top cover) cost of materials, labour, H.O.M of machinery complete as per specifications. Shutter size 3m x 2.8 m Specification No. KBS 7.10 / 7.12 (PWD SR 2014-15, Item No 7.5, Page 32)	Sqm	22.27	0.28	6.19	204.00	1,262.69
12	Providing and fixing top covers made out of 20 gauge M.S. sheet over pull and push rolling shutters bent to shape including cost of red lead primer coat of painting, materials, labour, H.O.M of machinery complete as per specifications. (PWD SR 2014-15, Item No 7.6, Page 32)	Mtr	6.10	0.13	0.81	204.00	155.51
13	KSRB 15.3.1 Providing 12mm thick cement plaster in single coat with cement mortar 1:3, to brick masonry including rounding off corners wherever required smooth rendering. : Providing and removing scaffolding, including cost of materials, labour, curing and complete as per specifications. (PWD SR 2014-15, Item No 15.9 Page 109)	Sqm	437.45	0.18	78.74	204.00	16,063.13
14	KSRB 15-14.1 : Providing and applying two coats with oil bound washable distemper of approved brand and shade on wall surface including priming coat with distemper primer after thoroughly brooming the surface free from mortar drops and other foreign matter including preparing the surface even and sand paper smooth, cost of materials, labour, complete as per specifications. (PWD SR 2014-15, Item No 15.49.1 Page113)	Sqm	226.55	0.06	13.82	204.00	2,819.20
15	KSRB 15-16.1 : Providing and finishing external walls in two coats with waterproof cement paint of approved brand and shade to give an even shade after thoroughly brooming the surface to remove all dirt and loose powdered material, free from mortar drops and other foreign matter cost of materials, labour, complete as per specifications. (PWD SR 2014-15, Item No 15.53.1 Page114)	Sqm	236.76	0.08	18.94	204.00	3,863.97
16	Electrification	LS					

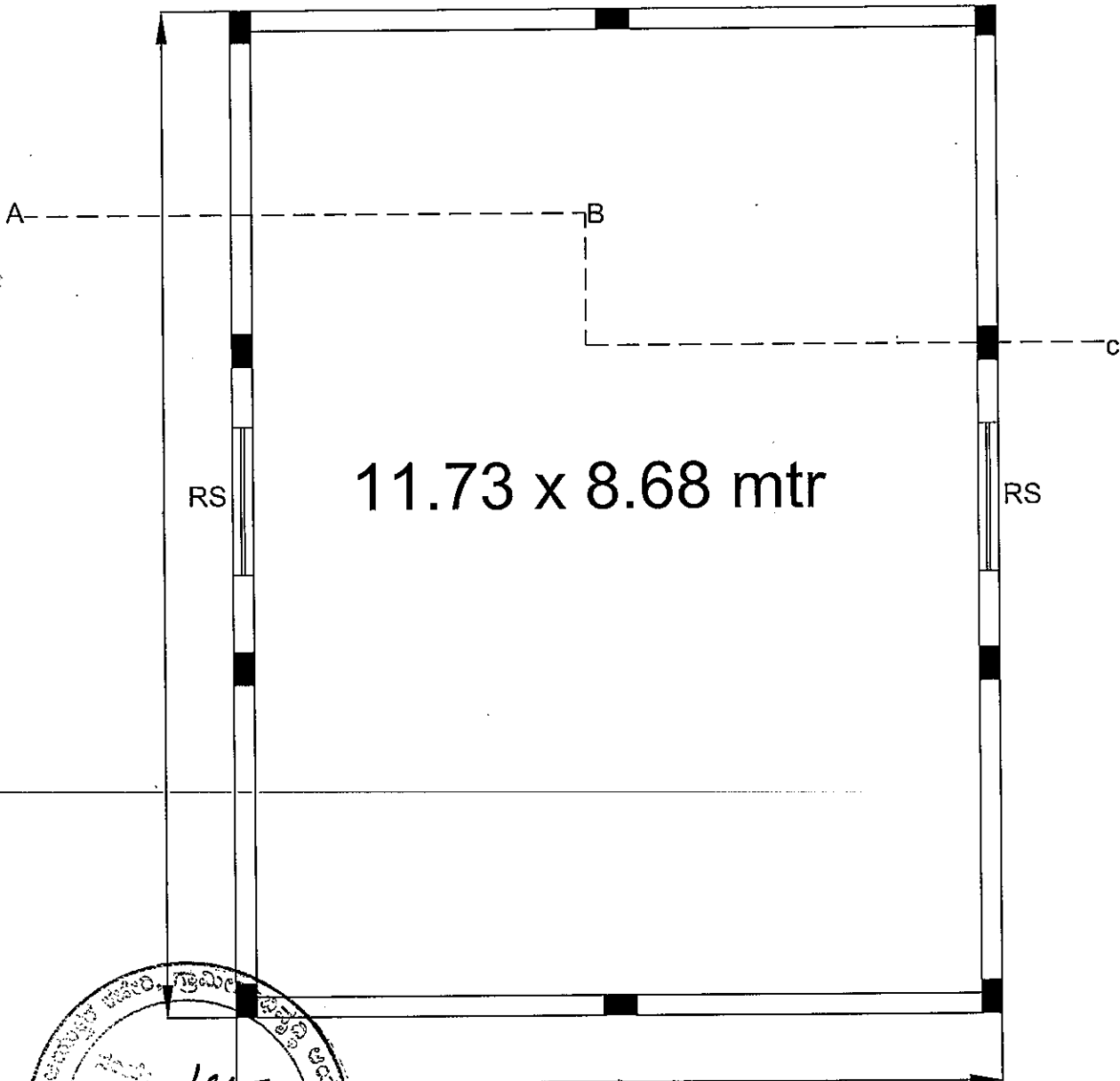

11.73 x 8.68 mtr

RS

RS

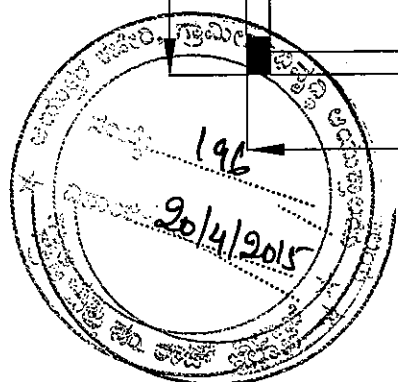

PLAN

PROPOSED PLAN FOR THE CONSTRUCTION OF  
GODOWN BUILDING

OPENING SCHEDULE

RS : 3.05 X 3.65M

V : 0.6 X 0.6

PLINTH AREA : 114.59 SQM



# PROPOSED PLAN FOR THE CONSTRUCTION OF GODOWN BUILDING

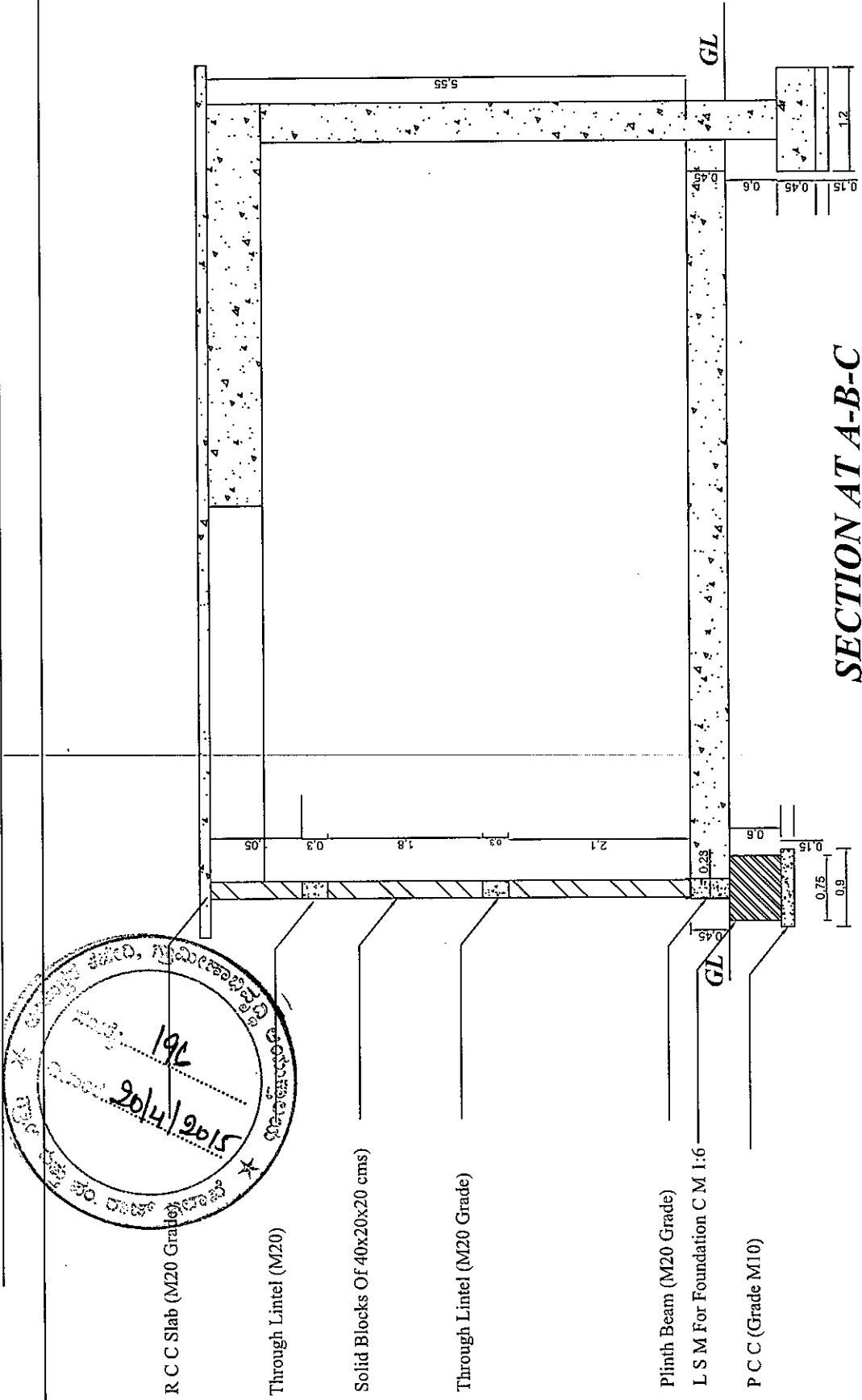

**SECTION AT A-B-C**

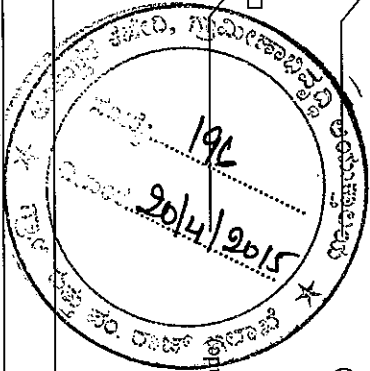

- R C C Slab (M20 Grade)
- Through Lintel (M20)
- Solid Blocks Of 40x20x20 cms)
- Through Lintel (M20 Grade)
- Plinth Beam (M20 Grade)
- L S M For Foundation C M 1:6
- P C C (Grade M10)